

SPECIFICATIONS

1. Current rating: 3A AC, DC
2. Voltage rating: 250V AC, DC
3. Temperature range: -40°C ~ +105°C
4. Insulation resistance: 1000MΩ/ min.
5. Withstanding voltage: 1000V AC/ minute.
6. Contact resistance: 20mΩ/ max.

Material:

Insulator: PA66 UL94 V-0
 Contact: Brass
 Plating: Tin plated over Nickel
 Mate with KR2501 series housing

Ordering Code:

C2501VD *** 01 T01 02PD
 No. of Circuits } 102:02, 116:16 } Plating T01: Tin plated
 Insulator Material }
 01: PA66 White V0
 22: PA66 Red V0
 22: PA66 Beige V0

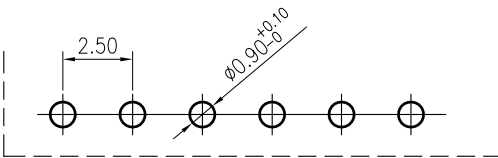
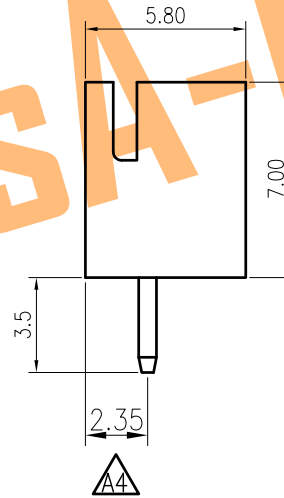
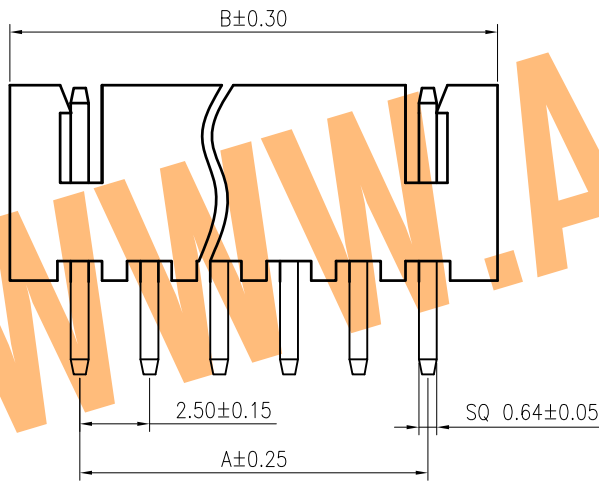

Recommended P.C.B. Layout
 Total tolerance: ±0.05mm

Circuits	Dimensions		Circuits	Dimensions	
	A	B		A	B
2	2.50	7.50	10	22.50	27.50
3	5.00	10.00	11	25.00	30.00
4	7.50	12.50	12	27.50	32.50
5	10.00	15.00	13	30.00	35.00
6	12.50	17.50	14	32.50	37.50
7	15.00	20.00	15	35.00	40.00
8	17.50	22.50	16	37.50	42.50
9	20.00	25.00			



AsA Electronic Co.

Tel : (+98) 21 66 73 56 82 Mob : (+98) 912 03 161 02

F	MARK	REVISION DESCRIPTION	SIGNATURE	DATE	TOLERANCE	TITLE:	DRAWN: Shen 2022.01.13	PART NO.: C2501VD***01T0102PD			
					X.X ±0.30	XH2.5 DIP 180°	CHECKED:				
					X.XX ±0.20	Wafer No K	APPROVED:				
					X.XXX ±0.10	UNIT:mm	SCALE:N/A	SHEET: 1/1	PROJECTION	REV.: A4	DRAWING NO.: 2501WVD102-D-S
1	2	3	4	5	6	7	8	9			